

# SharkBite Push-Fit Fittings

I.D. Pipe Size

## Coupling



16750	1/2" x 1/2"	
16751	3/4" x 3/4"	
16752	3/4" x 1/2"	

## Adapter



16753	1/2" Female	
16754	3/4" Female	
16755	1/2" Male	
16756	3/4" Male	

## Elbow



16757	1/2" x 1/2"	
16758	3/4" x 3/4"	
16759	3/4" x 1/2"	

## Tee



16761	1/2"x1/2"x1/2"	
16762	3/4"x3/4"x3/4"	
16763	3/4"x3/4"x1/2"	
16764	3/4"x1/2"x3/4"	
16765	3/4"x1/2"x1/2"	

## End Stop



16766	1/2"	
16767	3/4"	

## Drop Ear Elbow



16760	1/2" x 1/2"	
-------	-------------	--

## De-Mount Rings



16768	1/2"	
16769	3/4"	

## PushFit/Comp Straight Stop



16772	1/2"x3/8"	
-------	-----------	--

## Valve



16770	1/2"	
16771	3/4"	

## TYPICAL INSTALLATION

### Connecting a joint:

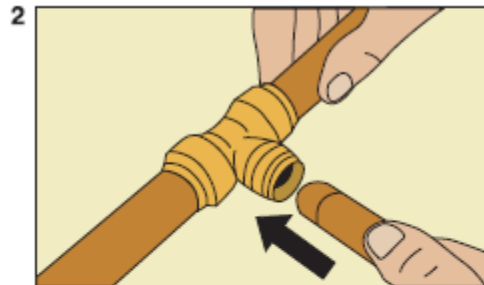
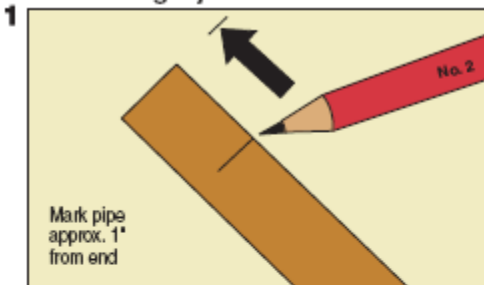

Push the pipe firmly with a twisting action until it clicks.  
Allow 1" clearance between the fitting and the wall for disconnection.

### Disconnecting a joint:

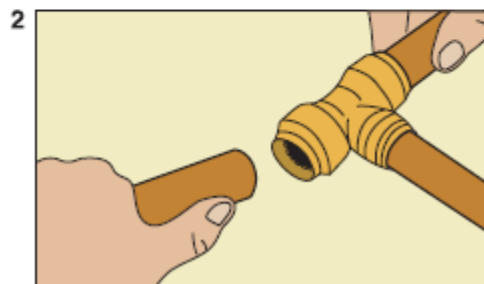
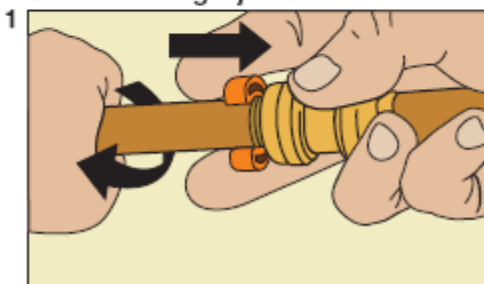

Push the disconnecting clip against the release collar and pull the pipe with a twisting action.

